

Slim KOMBAT - Slim XLIGHT - Slim

IDEAL FOR PRIMERS AND FINISHES IN BODYSHOPS AND INDUSTRIAL PAINTING

Slim has been synonymous with quality, reliability and versatility for over a decade, appreciated throughout the world of painting: from car refinish to industry, to carpentry.

Today Slim is joined by Slim KOMBAT, a new, unique and revolutionary version of the spray gun that made Walcom® history. Slim KOMBAT abandons the classic aluminum body and comes with an innovative magnesium body, over-injected in Kevlar® fiber (PAT. PENDING).

The lightness of magnesium, combined with the compactness and strength of Kevlar®, give life to a spray gun at only 345 g, also improved in performance, thanks to the new bodies and more powerful and concentrated air flows that allow better atomization of the product.

The characteristics of Kevlar® make this spray gun absolutely resistant to the aggressions of any type of solvent and chemical agent.

The surface characteristics also make it extremely easy to clean.

Slim KOMBAT is available in 3 versions: HVLP, HTE, HTE SR, which are united by the low air consumption (220-260 l/min), the high transfer efficiency (higher than 80% for the bottoms and 70% for bases and clear coats) and for the quality of product spreading and atomization.

The latest addition to the family, the Slim XLIGHT combines the reliability of the historic Slim model with new technical/technological solutions that make it more attractive, light, reliable and performing.

Matt nickel plating and laser engraving, lever and cap ring in composite material, new nozzle and flow channels give the spray gun:

- ease of cleaning and durability,
- weight of 455 g,
- fan and atomization of the highest level,
- better transfer efficiency.

These improved characteristics, combined with the consolidated one of the traditional SLIM, i.e. the reduced air consumption, the sturdiness and the performance reliability, make SLIM XLIGHT the new reference spray gun for painting in bodywork and industry, suitable for all types of varnish, from the bottom to the bases to the transparent.



Check the correct setup of the spray gun here, or visit www.walmeccom/solutionfinder

PAINTING DISTANCE

Between 10 and 15 cm for HVLP, between 15 and 20 cm for HTE, guarantees improved product layout on painted parts.

BOX

Cardboard box packaging includes: sprayguns, rebuild kit (spring, seals, air valve) wrench tool, mineral lube oil, instruction manual and warranty.

SUITCASE

Rigid plastic suitcase includes: spraygun, air control with gauge, rebuild kit (spring, seals, air valve), cup, wrench tool, mineral lube oil, instruction manual and warranty.



- 1 AIR ADJUSTMENT**
Completely open for total air flow.
- 2 AIR INLET PRESSURE**
Usage range 0.5 - 2.5 bar.
- 3 FAN PATTERN CONTROL**
From 0 to 5 turns of opening for a micrometric and ideal setting of the fan according to your needs.
- 4 MATERIAL FLOW CONTROL**
From 0 to 5 opening turns for a micrometric and ideal setting of the product delivery based on the paint and the speed of the operator.



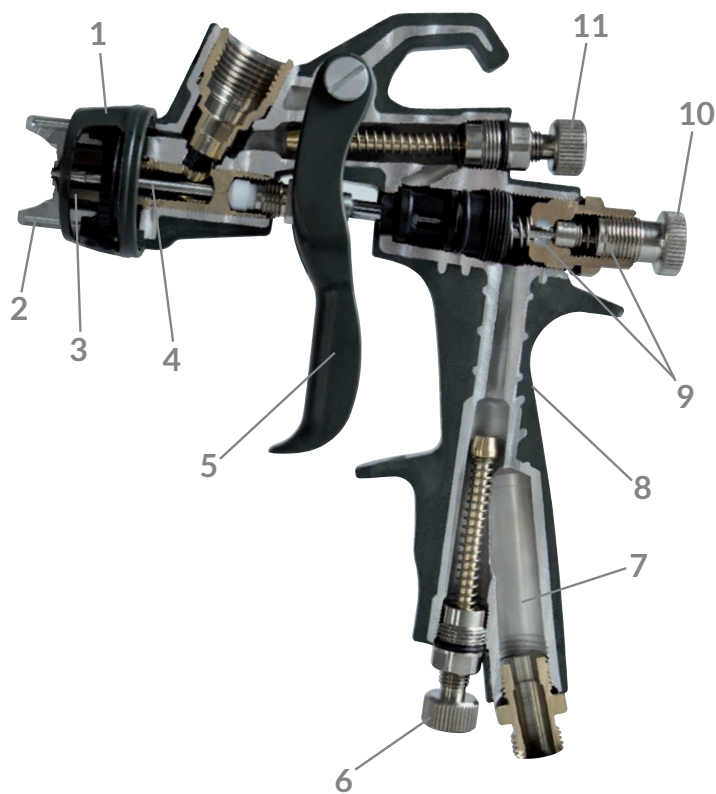

SLIM KOMBAT: product and specifications section

The spray gun is constructed with an air valve and needle on a single axis to provide higher performance and greater maintenance simplicity.

- 1 Kevlar fiber nut.
- 2 Anodized aluminum air cap.
- 3 Stainless steel nozzle.
- 4 Stainless steel needle.
- 5 Kevlar fiber lever.
- 6 Air flow regulation knob.
- 7 Calibrated air passages.
- 8 Magnesium and Kevlar fiber body.
- 9 Polished and chrome-plated aluminum body for total protection/ PTFE (Teflon) gaskets and valve, resistant to all water and solvent based paints with automatic adjustment system.
- 10 Product opening knob.
- 11 Fan adjustment knob.



- 1 **BODY:**
Die-casting magnesium over-injected kevlar fiber.
- 2 **NOZZLE:**
Monobloc stainless steel unit.
The holes for diffusion provide a constant and high volume air flow to the cap.
- 3 **AIR CAP:**
Anodize aluminum. Light and precise, it offers and guarantees performance over time.
The particular Anticorodal alloy guarantees resistance to any type of paint, solvent and pickling agent.
- 4 **NEEDLE:**
CNC processed stainless steel for maximum durability and guaranteed precision in nozzle alignment.